



## Rohrnieten

Aluminium, Kupfer,  
Messing, Stahl  
DIN 7340, ausgenommen\*

## Rivets tubulaires

aluminium, cuivre  
laiton, acier  
DIN 7340, \*excepté

## Tubular rivets

aluminium, copper  
brass, steel  
DIN 7340, \*excepted

Werkstoff:

AL = Aluminium  
CU = Kupfer  
MS = Messing  
ST = Stahl

Matière:

AL = aluminium  
CU = cuivre  
MS = laiton  
ST = acier

Material:

AL = aluminium  
CU = copper  
MS = brass  
ST = steel

Oberflächenbehandlung:

bl = blank (0)  
ag = versilbert (1)  
au = vergoldet (2)  
ni = vernickelt (5)  
sn = verzinkt (8)

Traitements de surface:

bl = brut (0)  
ag = argenté (1)  
au = doré (2)  
ni = nickelé (5)  
sn = étamé (8)

Surface-plating:

bl = clean (0)  
ag = silver-plated (1)  
au = gold-plated (2)  
ni = nickel-plated (5)  
sn = tin-plated (8)

**Bestellbeispiel:**  
**Exemple de commande:**  
**Example of order:**

**A40009020.60**  
(A4.0 x 0.2 x 0.9 MS bl)

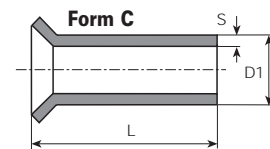
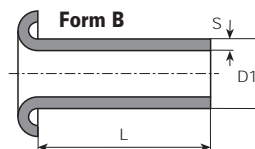
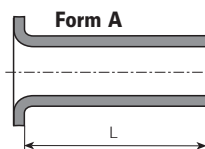

Form	øD1 mm	S mm	L mm	Werkstoff Matière Material	Stand.-Packg.		Artikel-Nr. Numéro d'article Part-No.
					2'000	5'000	
A*	4	0.2	0.9	MS		•	A40009020.6( )
A*	4	0.2	1.2	MS		•	A40012020.6( )
A*	4	0.2	1.5	MS		•	A40015020.6( )
A*	4	0.2	1.7	MS		•	A40017020.6( )
A*	4	0.2	1.8	MS		•	A40018020.6( )
A*	4	0.2	2	MS		•	A40020020.6( )
B*	4	0.4	2	AL		•	B40020040.10
A*	4	0.2	2.3	MS		•	A40023020.6( )
B*	4	0.3	3	MS	•		B40030030.6( )
B*	4	0.4	3	MS	•		B40030040.6( )
A*	4	0.3	3.5	MS	•		A40035030.6( )
B*	4	0.3	3.5	MS	•		B40035030.6( )
A*	4	0.2	4	MS	•		A40040020.6( )
B	4	0.3	4	MS	•		B40040030.6( )
C*	4	0.3	4	MS	•		C40040030.6( )
A	4	0.4	4	AL	•		A40040040.10
A	4	0.4	4	MS	•		A40040040.6( )
B*	4	0.4	4.2	AL	•		B40042040.10
A*	4	0.4	4.4	MS	•		A40044040.6( )
B*	4	0.3	4.5	MS	•		B40045030.6( )
B	4	0.3	5	MS	•		B40050030.6( )
A	4	0.4	5	MS	•		A40050040.6( )
B*	4	0.3	5.5	MS	•		B40055030.6( )
A*	4	0.4	5.5	MS	•		A40055040.6( )
B*	4	0.4	5.5	MS	•		B40055040.6( )
B	4	0.3	6	MS	•		B40060030.6( )
B	4	0.4	6	AL	•		B40060040.10
A	4	0.4	6	MS	•		A40060040.6( )
B	4	0.4	6	MS	•		B40060040.6( )
B*	4	0.3	6.5	MS	•		B40065030.6( )
B	4	0.3	7	MS	•		B40070030.6( )
A	4	0.4	7	AL	•		A40070040.10
A	4	0.4	7	MS	•		A40070040.6( )
A*	4	0.3	7.5	MS	•		A40075030.6( )
A	4	0.3	8	MS	•		A40080030.6( )
B	4	0.3	8	MS	1000		B40080030.6( )
A	4	0.4	8	MS	•		A40080040.6( )
B	4	0.4	8	MS	•		B40080040.6( )
A*	4	0.3	9	MS	•		A40090030.6( )
B*	4	0.3	9	MS	1000		B40090030.6( )
B*	4	0.4	9	MS	•		B40090040.6( )
A*	4	0.4	9.6	MS	•		A40096040.6( )

Form	øD1 mm	S mm	L mm	Werkstoff Matière Material	Stand.-Packg.		Artikel-Nr. Numéro d'article Part-No.
					1'000	2'000	
A*	4	0.25	10	MS	•		A40100025.6( )
A	4	0.3	10	MS	•		A40100030.6( )
B	4	0.3	10	MS	•		B40100030.6( )
A	4	0.4	10	MS	•		A40100040.6( )
B	4	0.4	10	MS	•		B40100040.6( )
B	4	0.5	10	MS	•		B40100050.6( )
B*	4	0.4	10.5	MS	•		B40105040.6( )
A*	4	0.2	11	MS	•		A40110020.6( )
A*	4	0.3	11	MS	•		A40110030.6( )
B*	4	0.4	11	MS	•		B40110040.6( )
C*	4	0.4	11	MS	•		C40110040.6( )
B*	4	0.5	11	MS	•		B40110050.6( )
B*	4	0.4	11.5	MS	•		B40115040.6( )
A	4	0.4	12	MS	•		A40120040.6( )
B	4	0.4	12	MS	•		B40120040.6( )
B*	4	0.3	13	MS	•		B40130030.6( )
A*	4	0.4	13	MS	•		A40130040.6( )
B*	4	0.4	13	MS	•		B40130040.6( )
B*	4	0.5	13	MS	•		B40130050.6( )
B*	4	0.4	13.5	MS	•		B40135040.6( )
B*	4	0.3	14	MS	•		B40140030.6( )
A*	4	0.4	14	MS	•		A40140040.6( )
B*	4	0.4	14	MS	•		B40140040.6( )
A	4	0.3	15	MS	•		A40150030.6( )
A	4	0.4	15	MS	•		A40150040.6( )
C*	4	0.4	15	MS	•		C40150040.6( )
B	4	0.5	15	MS	•		B40150050.6( )
B*	4	0.4	16	MS	•		B40160040.6( )
A*	4	0.3	17	MS	•		A40170030.6( )
B*	4	0.4	17	MS	•		B40170040.6( )
B*	4	0.2	18	MS	•		B40180020.6( )
B*	4	0.4	19	MS	•		B40190040.6( )
B	4	0.4	20	MS	•		B40200040.6( )
A*	4	0.75	20	MS	•		A40200075.6( )
B*	4	0.4	21	MS	•		B40210040.6( )
A	4	0.3	22	MS	•		A40220030.6( )
B	4	0.4	22	MS	•		B40220040.6( )
A*	4	0.4	23	MS	•		A40230040.6( )
B*	4	0.4	23	MS	•		B40230040.6( )
A	4	0.4	24	CU	•		B40240040.4( )
A	4	0.4	25	MS	•		A40250040.6( )
B	4	0.5	25	MS	•		B40250050.6( )
A*	4	0.4	26	MS	•		A40260040.6( )
B*	4	0.4	27	MS	•		B40270040.6( )

Andere Abmessungen auf Anfrage  
Nieteinsätze siehe Seite 584A

Autres dimensions sur demande  
Pièces de rechange voir page 584A

Further dimensions on request  
Inserts for pliers see page 584A



# Vogt Verbindungstechnik

Form	øD1 mm	S mm	L mm	Werkstoff Matière Material	Stand.-Packg.		Artikel-Nr. Numéro d'article Part-No.
					1'000	2'000	
A	4	0.3	28	MS	•		<b>A40280030.6( )</b>
A	4	0.4	28	MS	•		<b>A40280040.6( )</b>
A	4	0.4	30	MS	•		<b>A40300040.6( )</b>
B	4	0.4	30	MS	•		<b>B40300040.6( )</b>
B	4	0.5	30	MS	•		<b>B40300050.6( )</b>
B*	4	0.8	30	AL	•		<b>B40300080.10</b>
A*	4	0.3	33.2	MS	•		<b>A40332030.6( )</b>
B*	4	0.3	38	MS	500		<b>B40380030.6( )</b>
A	4	0.4	40	MS	500		<b>A40400040.6( )</b>
B	4	0.4	40	MS	500		<b>B40400040.6( )</b>
A	4	0.5	40	MS	500		<b>A40400050.6( )</b>
B*	4	0.4	42	MS	500		<b>B40420040.6( )</b>
B*	4	0.5	42.5	MS	500		<b>B40425050.6( )</b>
B*	4	0.5	48	MS	500		<b>B40480050.6( )</b>
B	4	0.5	50	MS	500		<b>B40500050.6( )</b>
B*	4	0.5	52.5	MS	500		<b>B40525050.6( )</b>
B	4	0.5	60	MS	500		<b>B40600050.6( )</b>
B*	4	0.5	62.5	MS	500		<b>B40625050.6( )</b>
B*	<b>4.5</b>	0.3	3	MS	•		<b>B45030030.6( )</b>
B*	4.5	0.25	4	MS	•		<b>B45040025.6( )</b>
B*	4.5	0.5	4	MS	•		<b>B45040050.6( )</b>
B*	4.5	0.3	10	MS	•		<b>B45100030.6( )</b>
A*	4.5	0.25	27.3	MS	•		<b>A45273025.6( )</b>
B*	4.5	0.25	35	MS	500		<b>B45350025.6( )</b>
A*	<b>4.8</b>	0.3	2.7	MS	•		<b>A48027030.6( )</b>
A*	4.8	0.4	4	MS	•		<b>A48040040.6( )</b>
B*	4.8	0.4	4	MS	•		<b>B48040040.6( )</b>
A*	4.8	0.4	6	MS	•		<b>A48060040.6( )</b>
B*	4.8	0.5	6	MS	•		<b>B48060050.6( )</b>
B*	4.8	0.4	8	MS	•		<b>B48080040.6( )</b>
A*	4.8	0.5	8	MS	•		<b>A48080050.6( )</b>
A*	<b>5</b>	0.25	2.6	MS	•		<b>A50026025.6( )</b>
A*	5	0.25	3	MS	•		<b>A50030025.6( )</b>
A*	5	0.25	4	MS	•		<b>A50040025.6( )</b>
A	5	0.5	4	MS	•		<b>A50040050.6( )</b>
B	5	0.5	4	MS	•		<b>B50040050.6( )</b>
A*	5	0.25	4.2	MS	•		<b>A50042025.6( )</b>
A*	5	0.25	4.3	MS	•		<b>A50043025.6( )</b>
A*	5	0.5	4.5	MS	•		<b>A50045050.6( )</b>
B*	5	0.5	4.5	MS	•		<b>B50045050.6( )</b>
B*	5	0.25	5	MS	•		<b>B50050025.6( )</b>
A	5	0.5	5	MS	•		<b>A50050050.6( )</b>
B	5	0.5	5	MS	•		<b>B50050050.6( )</b>
B	5	0.5	6	ST	•		<b>B50060050.9( )</b>
A*	5	0.5	6.5	MS	•		<b>A50065050.6( )</b>
B*	5	0.25	7	MS	•		<b>B50070025.6( )</b>
A	5	0.5	7	MS	•		<b>A50070050.6( )</b>
B*	5	0.25	8	MS	•		<b>B50080025.6( )</b>
A	5	0.5	8	CU	•		<b>A50080050.4( )</b>
A	5	0.5	8	MS	•		<b>A50080050.6( )</b>
B	5	0.5	8	MS	•		<b>B50080050.6( )</b>
A*	5	0.25	10	MS	•		<b>A50100025.6( )</b>
B*	5	0.25	10	MS	•		<b>B50100025.6( )</b>
A	5	0.5	10	MS	•		<b>A50100050.6( )</b>
B	5	0.5	10	MS	•		<b>B50100050.6( )</b>
A	5	0.5	10	ST	•		<b>A50100050.9( )</b>
A*	5	0.25	11	MS	•		<b>A50110025.6( )</b>
B*	5	0.75	11.5	MS	•		<b>B50115075.6( )</b>
B*	5	0.35	12	MS	•		<b>B50120035.6( )</b>
A	5	0.5	12	MS	•		<b>A50120050.6( )</b>
B	5	0.5	12	MS	•		<b>B50120050.6( )</b>
A*	5	0.25	13	MS	•		<b>A50130025.6( )</b>
B*	5	0.75	13.5	MS	•		<b>B50135075.6( )</b>
B*	5	0.25	14	MS	•		<b>B50140025.6( )</b>
B	5	0.5	15	MS	•		<b>B50150050.6( )</b>
B*	5	0.5	16	MS	500		<b>B50160050.6( )</b>
B*	5	1.0	16	MS	500		<b>B50160100.6( )</b>
B*	5	1.0	16	ST	500		<b>B50160100.9( )</b>
B*	5	0.5	17	MS	500		<b>B50170050.6( )</b>
B*	5	1.0	17	MS	500		<b>B50170100.6( )</b>

Form	øD1 mm	S mm	L mm	Werkstoff Matière Material	Stand.-Packg.		Artikel-Nr. Numéro d'article Part-No.
					500	1'000	
B*	5	0.25	17.3	MS	•		<b>B50173025.6( )</b>
B*	5	0.5	19	MS	•		<b>B50190050.6( )</b>
A	5	0.5	20	CU	•		<b>A50200050.4( )</b>
B	5	0.75	20	MS	•		<b>B50200075.6( )</b>
A*	5	0.5	22.5	MS	•		<b>A50225050.6( )</b>
A*	5	0.35	23	MS	•		<b>A50230035.6( )</b>
A	5	0.5	25	MS	•		<b>A50250050.6( )</b>
B	5	0.5	25	MS	•		<b>B50250050.6( )</b>
B*	5	0.75	26	MS	•		<b>B50260075.6( )</b>
B*	5	0.35	30	MS	•		<b>B50300035.6( )</b>
B	5	0.5	30	MS	•		<b>B50300050.6( )</b>
B	5	0.5	40	MS	•		<b>B50400050.6( )</b>
B	5	0.5	50	MS	•		<b>B50500050.6( )</b>
A*	<b>6</b>	0.25	3	MS	•		<b>A60030025.6( )</b>
B*	6	0.3	4	MS	•		<b>B60040030.6( )</b>
B*	6	0.25	5	MS	•		<b>B60050025.6( )</b>
B*	6	0.3	5	MS	•		<b>B60050030.6( )</b>
A*	6	0.25	6	MS	•		<b>A60060025.6( )</b>
B*	6	0.25	6	MS	•		<b>B60060025.6( )</b>
B	6	0.5	6	CU	•		<b>B60060050.4( )</b>
B	6	0.5	6	MS	•		<b>B60060050.6( )</b>
B	6	0.75	7	MS	•		<b>B60070075.6( )</b>
B*	6	0.25	8	MS	•		<b>B60080025.6( )</b>
A	6	0.5	8	MS	•		<b>A60080050.6( )</b>
A	6	0.75	8	MS	•		<b>A60080075.6( )</b>
A*	6	0.3	9	MS	•		<b>A60090030.6( )</b>
A	6	0.5	10	ST	•		<b>A60100050.9( )</b>
B*	6	0.5	11	MS	•		<b>B60110050.6( )</b>
A*	6	1.0	11.5	CU	•		<b>A60115100.4( )</b>
A	6	1.0	12	MS	•		<b>A60120100.6( )</b>
B*	6	0.5	12.5	MS	•		<b>B60125050.6( )</b>
A*	6	0.25	14	MS	•		<b>A60140025.6( )</b>
B*	6	0.25	14	MS	•		<b>B60140025.6( )</b>
B*	6	0.75	14	MS	•		<b>B60140075.6( )</b>
A	6	0.5	15	MS	•		<b>A60150050.6( )</b>
B	6	0.5	15	MS	•		<b>B60150050.6( )</b>
B*	6	0.5	15.5	MS	•		<b>B60155050.6( )</b>
B*	6	0.75	15.5	MS	•		<b>B60155075.6( )</b>
A*	6	0.5	16.5	MS	•		<b>A60165050.6( )</b>
B*	6	0.75	19	MS	•		<b>B60190075.6( )</b>
A*	6	0.25	19.5	MS	•		<b>A60195025.6( )</b>
B	6	0.5	20	MS	•		<b>B60200050.6( )</b>
B	6	0.5	28	ST	•		<b>B60280050.9( )</b>
B	6	0.5	30	MS	•		<b>B60300050.6( )</b>
A	6	0.5	35	MS	•		<b>A60350050.6( )</b>
A	6	0.5	40	MS	•		<b>A60400050.6( )</b>
B	6	0.5	40	MS	•		<b>B60400050.6( )</b>
A*	6	0.5	43	MS	•		<b>A60430050.6( )</b>
A	6	0.5	50	MS	•		<b>A60500050.6( )</b>
A*	<b>7</b>	0.5	9	MS	•		<b>A70090050.6( )</b>
A*	7	0.5	15	MS	•		<b>A70150050.6( )</b>
A*	<b>7.5</b>	0.25	5	MS	•		<b>A75050025.6( )</b>
A*	7.5	0.25	9.5	MS	•		<b>A75095025.6( )</b>
A*	7.5	0.25	11	MS	•		<b>A75110025.6( )</b>
B*	<b>8</b>	0.5	6	MS	•		<b>B80060050.6( )</b>
B*	8	0.5	6.5	MS	•		<b>B80065050.6( )</b>
A	8	0.5	10	MS	•		<b>A80100050.6( )</b>
B	8	0.5	10	MS	•		<b>B80100050.6( )</b>
A	8	0.5	15	MS	•		<b>A80150050.6( )</b>
A*	8	0.5	15.5	MS	•		<b>A80155050.6( )</b>
B*	8	0.5	17.5	AL	•		<b>B80175050.10</b>
B*	8	0.5	24.5	MS	•		<b>B80245050.6( )</b>
A	8	0.5	40	AL	•		<b>A80400050.10</b>
A*	<b>9</b>	1.0	6	ST	•		<b>A90060100.9( )</b>
A*	9	0.3	8	MS	•		<b>A90080030.6( )</b>
A*	9	0.3	10	MS	•		<b>A90100030.6( )</b>

Andere Abmessungen auf Anfrage  
 Nieteinsätze siehe Seite 584A

Autres dimensions sur demande  
 Pièces de rechange voir page 584A

Further dimensions on request  
 Inserts for pliers see page 584A